

4500 Lift and Slide System with thermal break

A perimetral sliding door system with thermal breaking and a bevelled or curved style both in sashes and beads.

There are two versions:

- **4500 lift and slide** that bases its operation on a system in which the sashes are fitted with a mechanism that permits its own elevation whilst opening and descending when closing in such a way that the closed door rests over the top and bottom longitudinal water tightness gaskets allowing it to be fixed in whatever position.

Possibility of corner sash meeting at 90° without mullions.

In the fixed light and sash configuration, the rail in the fixed zone remains hidden.

- **4500 in line slider** allows the sliders to be made economically in large dimensions.

It presents configurations of sash+fixed light, Fixed light+sash+fixed light, 2 sashes+2 fixed lights and 4 sashes.

The rail where the sashes slide along is made of stainless steel in order to avoid wear and tear.



4500 Lift and Slide System with thermal break

Transmittance

Uw from 1,5 (W/m²K)

Please consult typology, dimensions and glass

Acoustic insulation

Maximum glazing: 30 mm.

Maximum acoustic insulation **Rw=42 dBA**

Finishes

Possibility of dual colour

Colour powder coating (RAL, mottled and rough)

Wood effect powder coating

Anti-bacterial powder coating

Anodized

Categories achieved at test centre

Air permeability
(EN 12207:2000): Class 3

Water tightness
(EN 12208:2000): Class 8A

Wind resistance
(EN 12210:2000): Class C4
Reference test 1,85 x 2,05 m. 1 sash + 1 fixed light



Sections

Frame 100/123/127 mm.
185 mm. 3 rails

Sash 51 mm.

Polyamide strip length

-Lift version of 24 & 14.6 mm.

-In-line version of 30 & 14.6 mm.

Profile thickness

Door 2,0 mm.

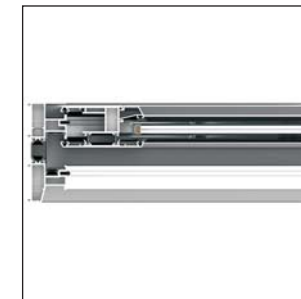
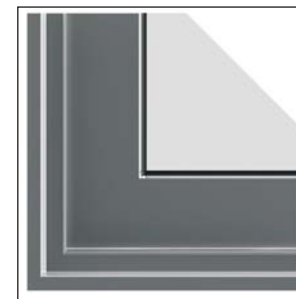
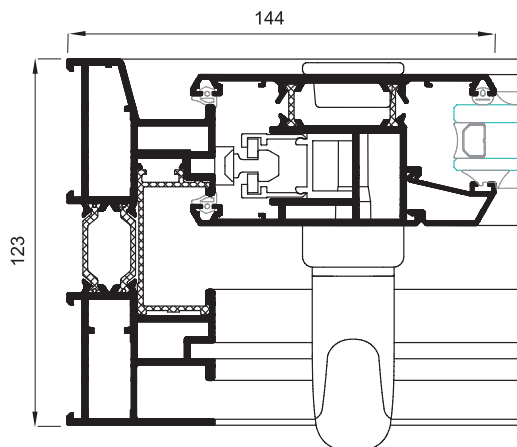

Opening possibilities

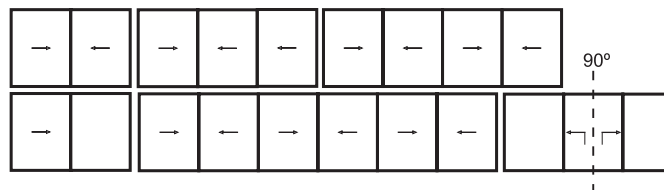

Sliding of 2, 3, 4 & 6 sashes.
Possibility of 3 rails.
Possibility of 1 rail.
(1 sash + 1 fixed light)
Possibility of corner sash at 90° without mullions.

Maximum dimensions

Width (L) = 6.700 mm.
Height (H) = 2.900 mm.
2 sashes door

Maximum weight/sash

400 Kg.(Lift version)
280 Kg.(In-line version)

Please consult regarding maximum weight and dimensions for other opening types